



Pulse-8 is a compact and stylish desk-top unit providing flexible modular power and data distribution; ideal for office desks and screens. PULSE 'floats' above the desk presenting clean, simple lines with no-nonsense understated function and uncompromising style.

Add a splash of colour to your world with the new Pulse-8 range from OE Elsafe. Based on our top selling Pulse unit, Pulse-8 is now available to order in a choice of 8 lively colours with either black or grey sockets.

Pulse-8 can be specified with a wide range of Elsafe's modular power, data and AV sockets including our class leading TUF-PD and TUF-R USB fast charger.

In addition, multiple bracket options allow Pulse-8 to be fitted to desktops, screens, tool / equipment rails and many other locations.



pulse-8 TECHNICAL

Common Modular Components*

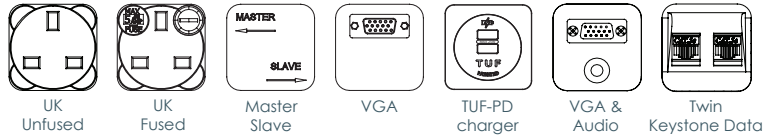
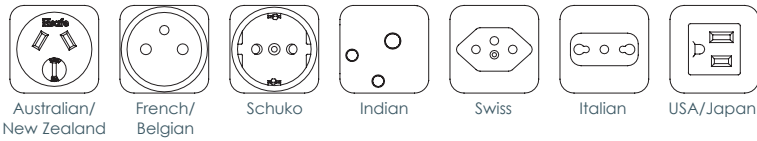

Unit dimensions

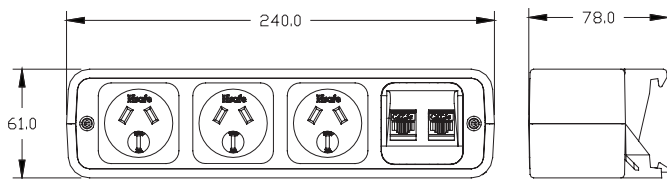

Common Units

Other configurations are available on request

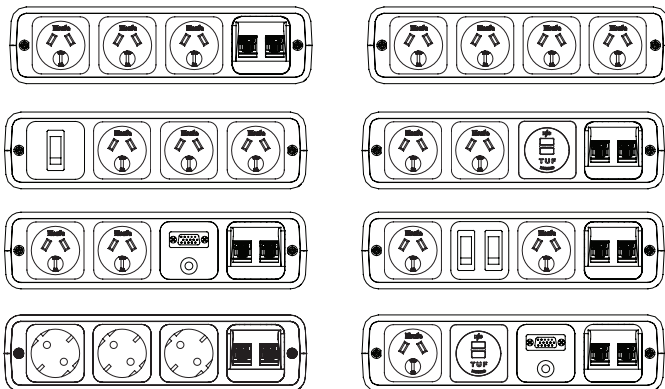

Fixings

| | |
|-----|---|
| PCB | Clamp Bracket 18 - 35mm |
| PEC | Clamp Bracket (Extended) 38-55mm ⁺ |
| PLC | Clamp Bracket (Long-Reach) 18-35mm ⁺ |
| PTR | Tool rail fixing* |
| HTC | HT Beam fixing |

*Please call to confirm screen/toolrail compatibility
+Available on application



Features

Configuration:

Power only / Data only / Combined (Power & Data/AV)

Internal segregation between Power and Data/AV in combined PULSE

Insulation:

Reinforced insulation

Earth Bonding:

A 250mm earth lead can be included to allow earth bonding to furniture. (country specific requirements)

Testing:

100% testing - continuity, polarity, insulation & earth

Soft Wiring (power)

Power wired to Wieland GST connector allows starter cables to be changed to suit requirements, especially useful during moves and changes (CHURN)

Angled cable grip means the cable can exit via the rear or the bottom without the need for tools, allowing flexibility for mounting PULSE

Soft Wired Data / AV

As well as soft-wired power, PULSE-8 can be supplied with pre-fabricated (100% end-of-line tested) fly-leads for data (CAT5e, CAT6, CAT7) and AV connections thereby providing a complete 'plug-and-play' soft wiring solution. If necessary, branded data can be accommodated to retain full channel warranties, please call for advice (see our Soft Wiring Data Brochure)

PTR - Screen Fixing

Standard tool-rail bracket
Please call for confirmation

HTC - HT Beam

fixing - suitable for
fixing to HT Beam

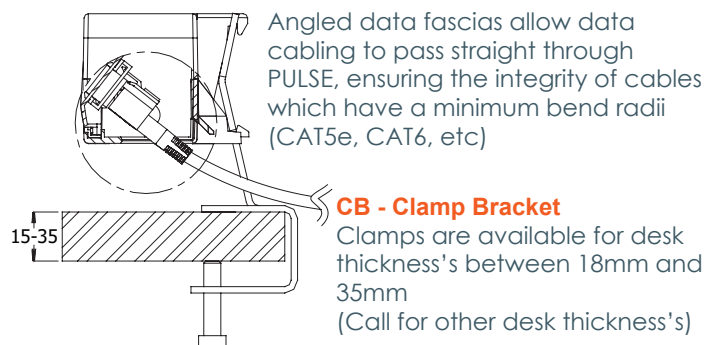
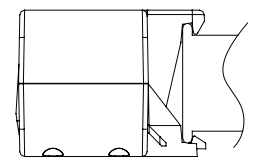
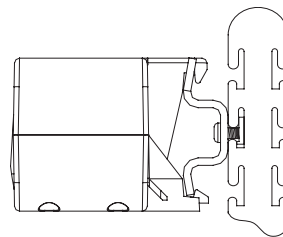

CB - Clamp Bracket

Clamps are available for desk thickness's between 18mm and 35mm
(Call for other desk thickness's)